

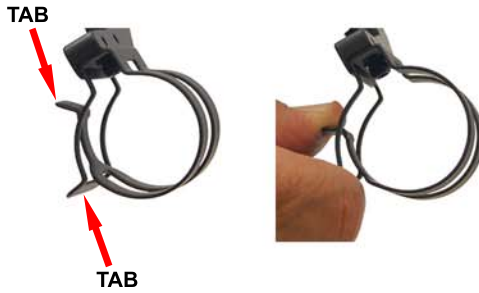

INSTALLATION INSTRUCTIONS FOR BLACKVUE DR750S, DR650S



**1 -** To install the dashcam into the mount, simply squeeze the two tabs of the spring clip together as shown above. This will increase the diameter of the spring clip and allow you to slide the dashcam into position. Once the dashcam is in position, release the two tabs. The dashcam is now securely attached to the mount.



**2 -** Install mount from passenger side of vehicle. Loosen right half of mount clamp by removing top screw. Position mount around the mirror stem as shown above.



**3 -** Reattach right side of mount clamp. Leave top screw loose so mount can slide towards the windshield around large diameter of mirror stem.



**4 -** After adjustments are made, check that hinge pivot and vertical adjustment screws are tight. Grab long arm of allen wrench to tighten screws (fig. 6A). The screw on very top of mount should be tightened last, and does not need to be quite as tight as other screws. Grab short arm of allen wrench to tighten top screw (fig. 6B) to prevent overtightening.

**BLENDMOUNT ADJUSTMENTS**

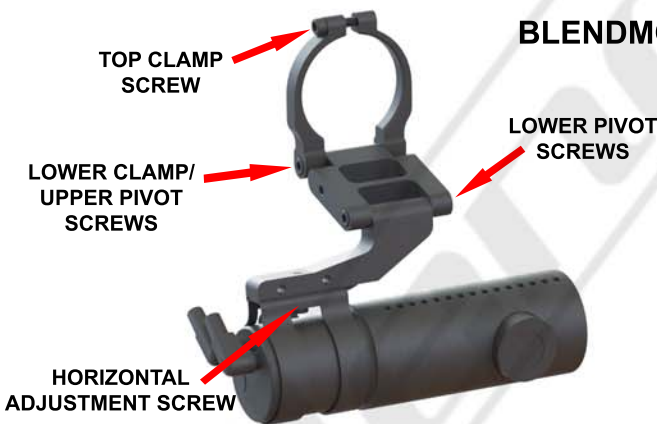

**5 -** Using the upper and lower pivot screws, adjust the mount to achieve your desired location of the dashcam. We recommend adjusting it as high as you can. You can also use the spring clip horizontal adjustment screw to help center the dashcam with the mirror as shown above.

FOR MORE INFO VISIT [www.blendmount.com/videos](http://www.blendmount.com/videos)

**CAUTION**

**DO NOT** use this mount if it interferes with the adjustability or the operation of your rear view mirror in any way.

**DO NOT** use this mount if the dashcam creates an unsafe viewing obstruction.

**DO NOT** ATTEMPT TO MODIFY THIS PRODUCT. Consult the manufacturer for assistance.

All BlendMount products are accompanied with detailed installation instructions and adjustment tips. You are encouraged to contact [customerservice@blendmount.com](mailto:customerservice@blendmount.com) or call J28 Design at 1-888-497-8388 for further assistance.

Check the BlendMount Forum for installation tips and some vehicle specific installs.

[www.blendmount.com](http://www.blendmount.com)

Your feedback is very important to us. Please email any questions or comments you have to [customerservice@blendmount.com](mailto:customerservice@blendmount.com)



**Innovative Design And  
Precision Manufacturing**

BlendMount - US PATENT # D625,580 S, D656,811 S, D653,980 S, D690,245 S, D690,246 S, D690,247 S and other patents pending